

CONSTRAINT MAP

"OAK CREEK CANYON"

CITY OF CLAYTON
APN: 118-370-052

SUBDIVISION 6826

CITY OF CLAYTON
COUNTY OF CONTRA COSTA
STATE OF CALIFORNIA

CITY OF CLAYTON
118-370-052

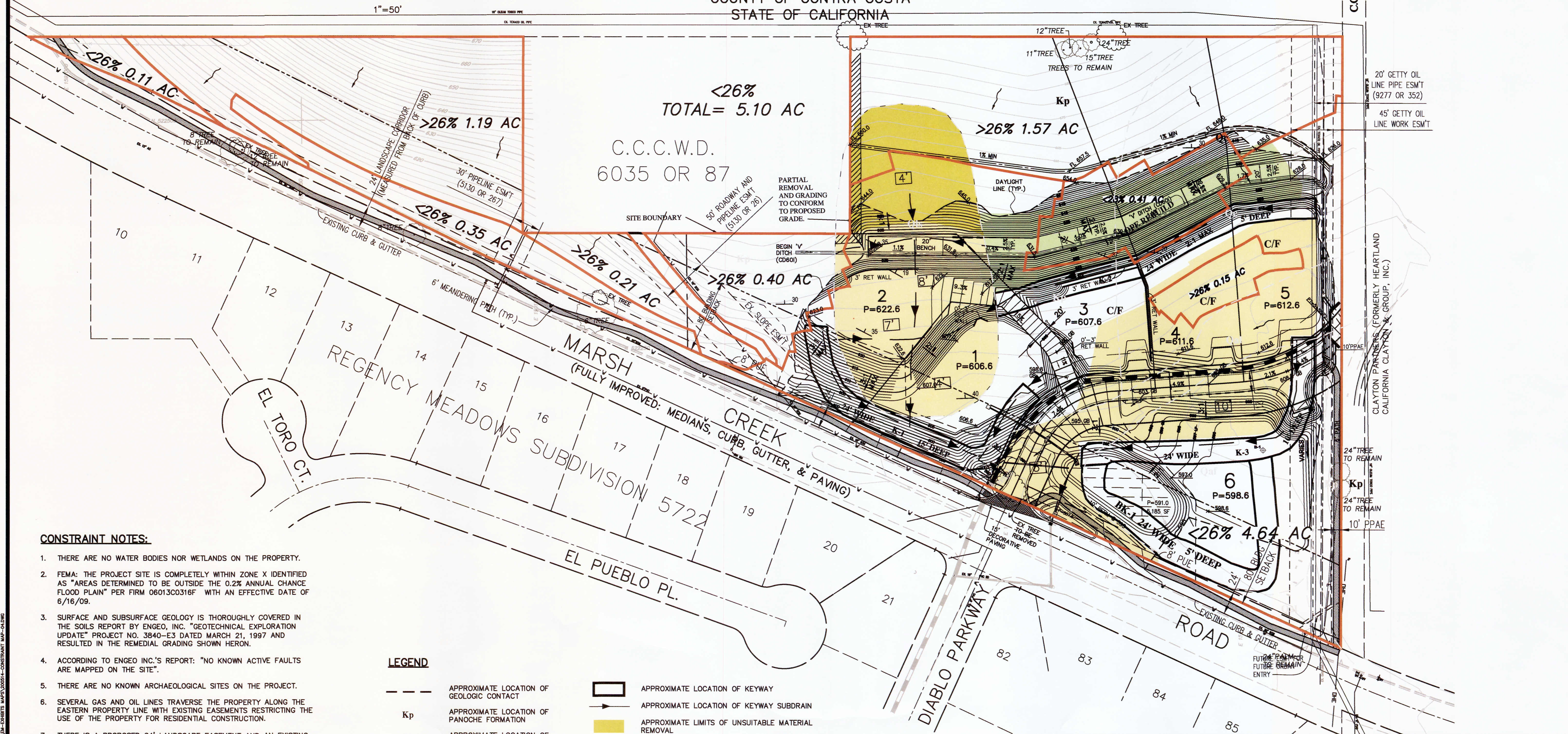
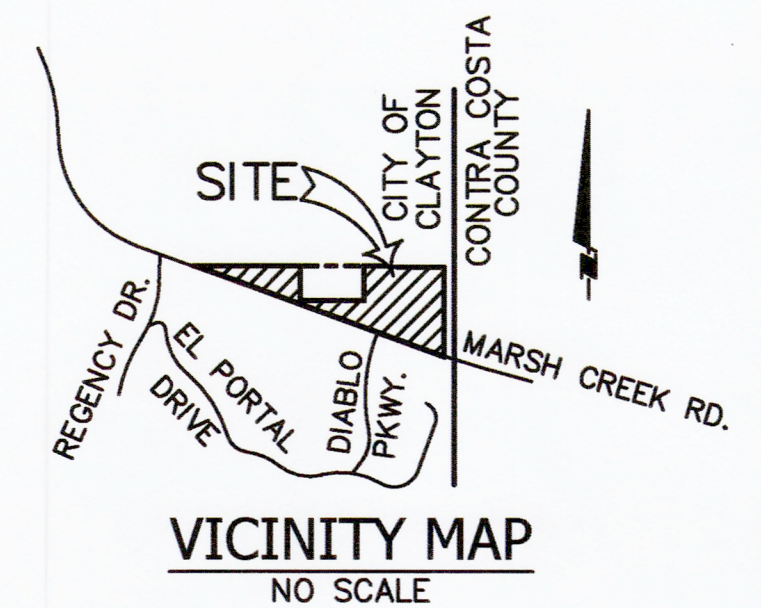

CONSTRAINT NOTES:

1. THERE ARE NO WATER BODIES NOR WETLANDS ON THE PROPERTY.
2. FEMA: THE PROJECT SITE IS COMPLETELY WITHIN ZONE X IDENTIFIED AS "AREAS DETERMINED TO BE OUTSIDE THE 0.2% ANNUAL CHANCE FLOOD PLAIN" PER FIRM 06013C0316F WITH AN EFFECTIVE DATE OF 6/16/09.
3. SURFACE AND SUBSURFACE GEOLOGY IS THOROUGHLY COVERED IN THE SOILS REPORT BY ENGeo, INC. "GEOTECHNICAL EXPLORATION UPDATE" PROJECT NO. 3840-E3 DATED MARCH 21, 1997 AND RESULTED IN THE REMEDIAL GRADING SHOWN HEREON.
4. ACCORDING TO ENGeo INC.'S REPORT: "NO KNOWN ACTIVE FAULTS ARE MAPPED ON THE SITE".
5. THERE ARE NO KNOWN ARCHAEOLOGICAL SITES ON THE PROJECT.
6. SEVERAL GAS AND OIL LINES TRAVERSE THE PROPERTY ALONG THE EASTERN PROPERTY LINE WITH EXISTING EASEMENTS RESTRICTING THE USE OF THE PROPERTY FOR RESIDENTIAL CONSTRUCTION.
7. THERE IS A PROPOSED 24' LANDSCAPE EASEMENT AND AN EXISTING 80' STRUCTURE SETBACK, "SCENIC CORRIDOR", ALONG THE RIGHT OF WAY OF MARSH CREEK ROAD ADDING HIGHWAY BEAUTIFICATION BUT ALSO REDUCING HOME CONSTRUCTION.
8. THE WESTERN PORTION OF THE PROPERTY IS LONG AND TRIANGULAR IN SHAPE SLOPING TO THE EXISTING CURB WITH A 25' PAVED EASEMENT TO CCWD'S WATER RESERVOIR BISECTING THE LAND. THIS LEAVES LITTLE AREA FOR RESIDENTIAL CONSTRUCTION.
9. SMALL BIORETENTION C.3 AREAS REQUIRED BY OUR STORM WATER CONTROL PLAN FURTHER RESTRICTS RESIDENTIAL CONSTRUCTION.

LEGEND

| | | | |
|-----|---|-----|---|
| --- | APPROXIMATE LOCATION OF GEOLOGIC CONTACT | □ | APPROXIMATE LOCATION OF KEYWAY |
| Kp | APPROXIMATE LOCATION OF PANOCHE FORMATION | → | APPROXIMATE LOCATION OF KEYWAY SUBDRAIN |
| Qls | APPROXIMATE LOCATION OF SHALLOW LANDSLIDE | ■ | APPROXIMATE LIMITS OF UNSUITABLE MATERIAL REMOVAL |
| Qaf | APPROXIMATE LOCATION OF ARTIFICIAL FILL | ■ | APPROXIMATE LIMITS OF UNSUITABLE MATERIAL REMOVAL AND REPLACEMENT |
| Qal | APPROXIMATE LOCATION OF ALLUVIUM | 10' | APPROXIMATE DEPTH OF REMOVAL |
| Qc | APPROXIMATE LOCATION OF COLLUVIUM | ■ | APPROXIMATE LIMITS OF SLOPE REBUILD |
| ~ | STRIKE AND DIP | C/F | CUT / FILL TRANSITION LOT |
| | | F | FILL LOT |

| | | | | | |
|------------------|------------------|---------------|-----------------|-----------------|--------------|
| DATE: 03-18-2020 | DESIGNED BY: DOI | DRAWN BY: RLB | CHECKED BY: DOI | JOB NO.: 200514 | SHEET 1 OF 1 |
|------------------|------------------|---------------|-----------------|-----------------|--------------|

SUBDIVISION 6826
CLAYTON
CONTRA COSTA COUNTY
CALIFORNIA

CONSTRAINT MAP

Isakson & Assoc. Inc.
civil engineering & land surveying
2 Mirango Court, Clayton, CA. 94517 Phone: (925) 876-0889